

1840

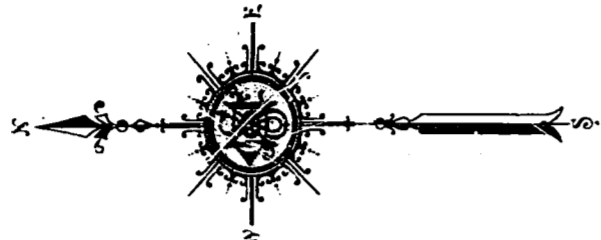
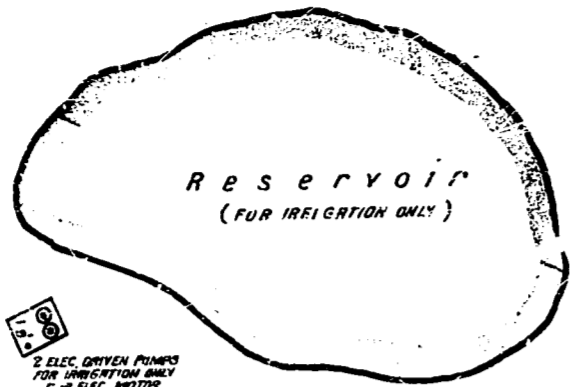

COTTAGE GARDEN NURSERIES

-Located 2 Miles S.E. of Court Ho.-

NIGHT WATCHMAN, NO CLOCK; POWER & LIGHTS ELECTRIC; HEAT, STEAM & HOT WATER; FUEL: OIL AND WOOD; CITY WATER; ONE 2 M. HYD. WITH 30' HOSE; WATER FROM RESERVOIR BY ELEC. DRIVEN PUMPS FOR IRRIGATION PURPOSES.

1841

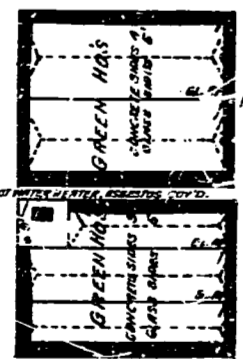
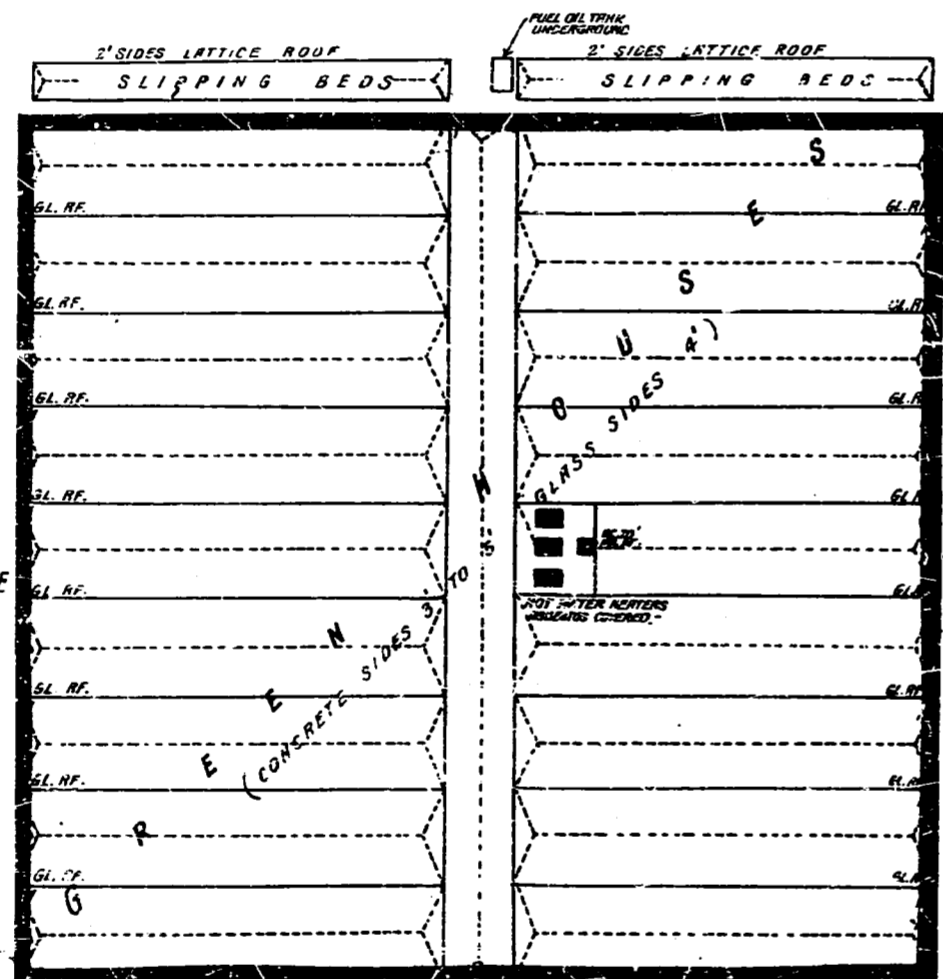

1842

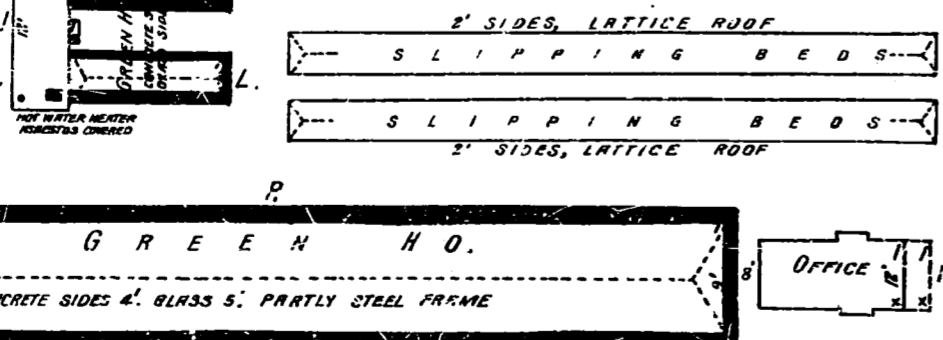

25' HO. Irrigation System

25' HO. Irrigation System

25' HO. Irrigation System

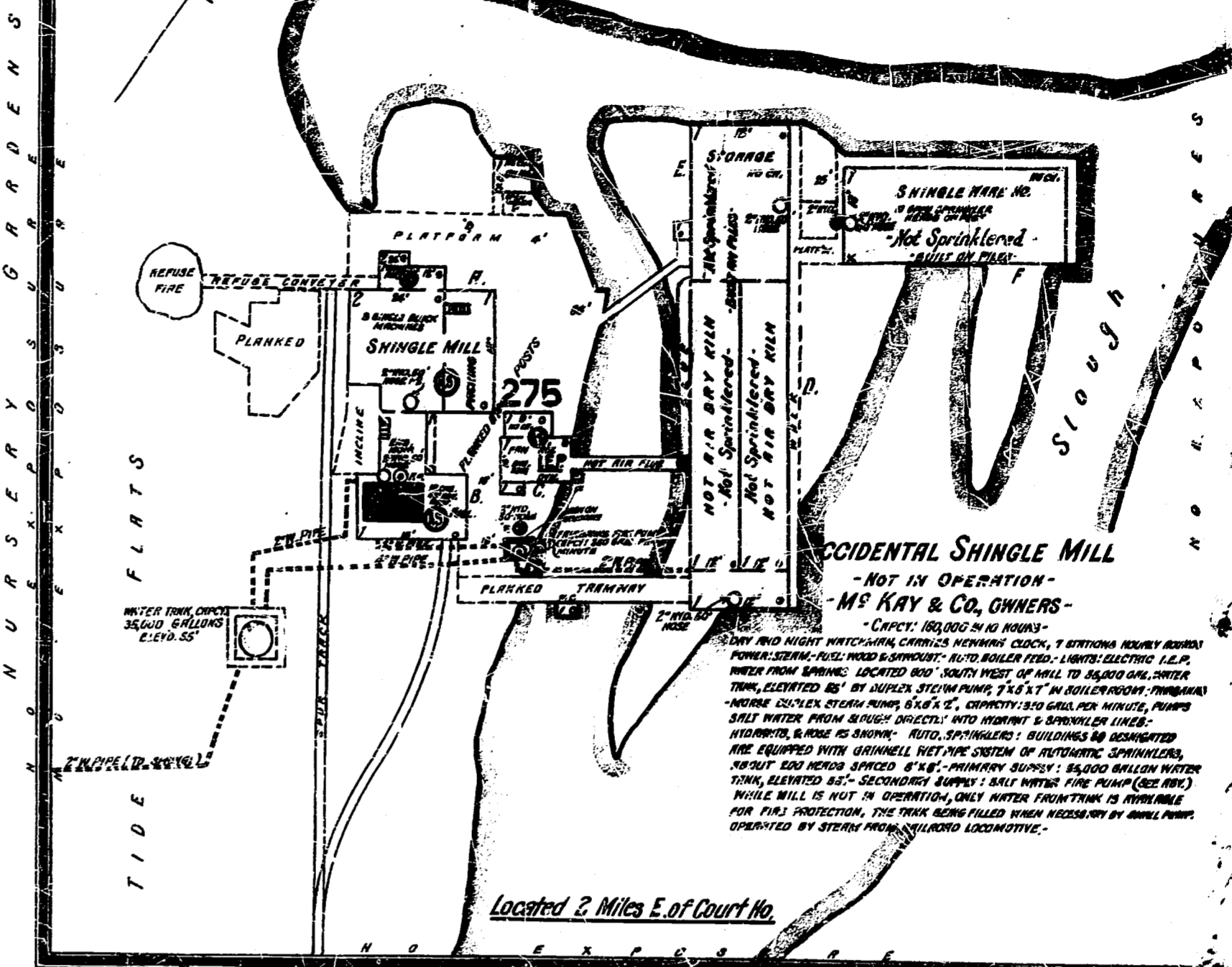
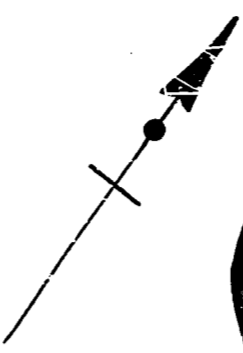
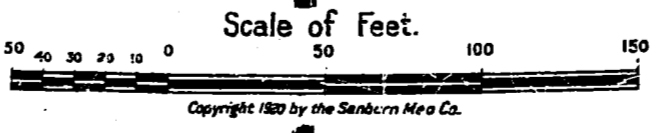

-Located 2 Miles E. of Court Ho.

COUNTY RD

COUNTY RD

NURSERIES GARDENS BEYOND

TIMBER

SCATTERED PILES CORD WOOD

263

Mc CABE DUPREY TANNING CO.

PARALLEL LINES ON PREVIOUS

BUILDING FOR TANNING PURPOSES - POWER ELECTRIC & SYSTEM - FUEL: WOOD & OLD BARK; NO WATCHMAN - WATER PUMPED FROM 7 WATER TRENDS, WHICH ARE FILLED BY GRAVITY FROM SPRINGS, TO 15,000 GAL. WATER TANK ON HILLSIDE, 15 FT. ABOVE FLOOR OF TANNING, BY A GRINDER'S DUPLEX STEAM PUMP 2 1/2" x 3" x 5" - 2 SMALL ELECTRIC DRIVEN PUMPS IN BELLIE, DIRECT PRESSURE FROM STEAM PUMP IN CASE OF THE 250 FT. OF 1 1/2" HOSE - HYDRANTS & HOSE AS SHOWN, 1 DOZEN JACKS -

-Located 4 1/2 Miles E. of Eureka on Arata Road

WATER TRENDS ON GROUND, FILLED BY GRAVITY FROM SPRINGS